

water sensitive urban design analysis and design reports

Water Sensitive Urban Design (WSUD) is a rapidly expanding field based on ideas for innovative alternatives to piped drainage. The **ADW Johnson** engineering team has a detailed understanding of the evolving techniques.

The team has analysed WSUD devices at all levels from design, authority, community acceptance, practicality, cost and ease of construction and ongoing monitoring maintenance and performance. The benefit to our clients include recommending devices with practical and cost effective results.

Projects

Aged Care Facility,
Kanwal

Bounty Close,
Tuggerah

Coastal Hamlets,
Catherine Hill Bay

Government Road,
Thornton North

Delroy Park Estate,
Dubbo

“Horizons” Village,
Dubbo

Murrays Beach,
Wallarah Peninsular

Sanctuary Estate,
Fletcher

Wadalba Wildlife Corridor,
Wadalba

Wadalba Wildlife Corridor, Wadalba

Undisturbed environmentally
sensitive land bisecting the Wadalba
Urban Release Area



Key issues: preparation of stormwater management strategy and flood modelling to determine appropriate development offsets. Determining appropriate water quality treatment measures utilising WSUD techniques to protect the existing Wildlife Corridor.

Sanctuary Estate, Fletcher

700 lot staged residential subdivision



Key issues: implementation of estate based stormwater management strategy. Stage 1 utilised linear bioretention swales to the perimeter of the residential subdivision to treat stormwater prior to discharging into receiving waters.

Government Road, Thornton North

200 and 400 lot staged residential
subdivisions

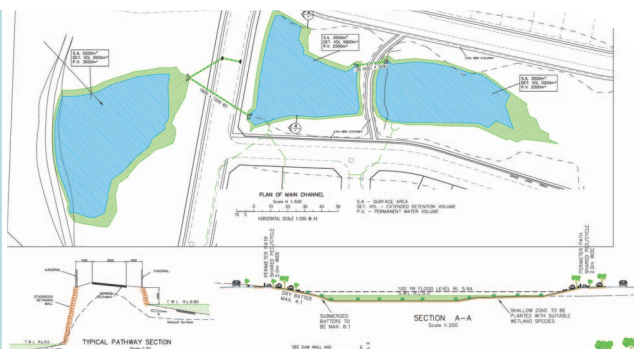

Key issues: preparation of the development of the stormwater management plan. WSUD analysis and options reporting including use of infiltration and sediment basin as well as small wetlands.